

JCJ ARCHITECTURE

September 24, 2012

Linda Searl, FAIA,
Chair, 2012 Jury of Fellows
The American Institute of Architects
1735 New York Avenue, NW
Washington, DC 20006-5292

RE: James E. LaPosta, Jr., AIA, LEED AP
FAIA Fellowship Nomination

Dear Chairperson Searl,

I am pleased and honored to sponsor Jim LaPosta, AIA for elevation to the AIA College of Fellows. I have known and worked with Jim over the last 25 years and highly support his nomination and elevation with great enthusiasm to the AIA's College of Fellows. Jim has exceptional talent and passion for the profession of architecture and through his work, has contributed immensely to the enhancement of the built environment through a community centered approach to design excellence. This is particularly true relative to his work in the category of educational projects, where he is especially accomplished in promoting design excellence as a way of connecting people to promote learning. Jim is a great communicator in working with clients, the public at large and in teaching young architects and staff within the firm.

Jim is a dedicated local and national leader who has committed himself to the design of high quality learning environments which respect and sustain the context of their respective settings. He brings exceptional skills through his personal presence in bringing diverse constituent groups together to resolve complex, controversial issues by building consensus and support, especially in public forums. Jim's many accomplishments have been widely reported and acclaimed in public media. He is a highly respected architect by all of those he has worked with through the years.

Jim has contributed his time and energy to many organizations, especially those connected locally and nationally to the practice of architecture. He has been in the forefront of promoting use of electronic and social media to reach constituent groups in promoting the benefits of design excellence and the valued role of the architect in advancing educational initiatives. Jim is recognized by educators both locally and nationally for his tireless commitment of time and energy working with user groups to advance the learning experience in rich, physical settings.

He truly deserves elevation to the College of Fellows and would be a valued addition to this accomplished group of architects. It is time that Jim is recognized for this high honor.

Best regards,

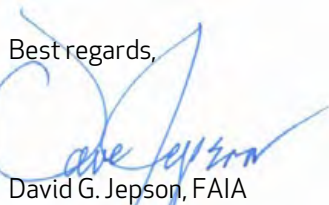

David G. Jepson, FAIA
Principal

Enclosure

SECTION 1

SUMMARY

JAMES E. LAPOSTA, JR., AIA, LEED AP; JCJ ARCHITECTURE

SUMMARY STATEMENT

James LaPosta has advanced the practice of educational architecture by combining advocacy for design excellence with a community-centered approach to create places that promote personal connection and support innovative ways to teach and learn.

SUMMARY OF ACHIEVEMENTS



Community Building

As a Principal and JCJ's Chief Architectural Officer, Jim has **created a firm culture that focuses on responding to all the voices of a community**; teachers, students, parents, neighbors, taxpayers, civic leaders and administrators. Perhaps because his father is a public school teacher, Jim loves talking with educators and has **dedicated his career to fostering a dialogue about the educational process and how buildings can respond**. Jim has established the firm's reputation for **bringing together communities, explain complicated issues, and using the design process to solve problems**. In Portsmouth New Hampshire, his leadership brought successful closure to a 10-year public debate over the location and design of a new middle school. His talent for building consensus led to the successful re-use of the historic downtown middle school, creating a sustainable educational facility uniquely tied to its context.



Design Excellence

Jim has pioneered the **design of buildings that support communities of learners**. Jim has developed a design language of open transparent places that are easy to navigate, promote the serendipitous encounter and encourage active learning. He has championed a specific set of beliefs about educational design that continue to drive his work. **Honor the learner's space**: respond to the physical, social and emotional needs of learner at every age; **Agile Environments**: incorporate flexibility to empower learning communities to quickly and routinely alter their learning space; **Gathering Places**: create places for people to come together in formal and informal ways; **Tread Lightly**: guide and manage project sustainability to enable learning communities to be good stewards of the environment. His portfolio includes numerous LEED, CHPS, and Energy Star projects. He consistently creates welcoming environments through the skillful use of color, texture, light, and sound. He believes that learning happens best in comfortable places.



Thought Leader and Practice Advocate

Jim has also advanced the practice of educational facility design by **serving as a juror and senior committee member at the national and state level**. Jim has dedicated significant energy to elevating the national conversation about the design of learning environments. As a **member of the Leadership Group of the AIA Committee on Architecture for Education** he has been a tireless advocate for thoughtful, responsive, and sustainable school design. He was a juror for the 2003 and 2004 AIA CAE National Design Awards. As National Chair of the CAE in 2008, Jim led the way in re-establishing and strengthening connections with international partners as he developed the successful Global Perspectives on Pedagogy and Design Conference in Helsinki, Finland. After his term on the CAE Leadership Group ended, he has remained an **active leader as he pioneered the use of social media to actively engage a world-wide audience for CAE content**. He was invited by the **American Architectural Foundation as a resource team expert** for the first National School Design Charrette in Washington DC. Over the last 8 years he has been an AAF resource team member on numerous occasions including a visit to assist Mississippi Gulf Coast districts rebuild shortly after Hurricane Katrina. Jim has been a frequent presenter on educational facility design at the AIA National Convention as well as other national organizations concerned with education.

SECTION 2

ACCOMPLISHMENTS

2.1 SIGNIFICANT WORK: JAMES E. LAPOSTA, JR., AIA, LEED AP

SIGNIFICANT WORK

For Projects dated 1997-2014, James LaPosta's role is Principal in Charge and/or Design Principal
For Projects dated before 1997, James LaPosta's role is Design Architect

2014 (anticipated completion)

World of Inquiry School
Rochester, NY

Southwick Tolland Granville Regional High School
Southwick, MA

Woodland Elementary School
Southwick, MA

2013 (anticipated completion)

Fairchild Wheeler Multi Magnet High School
Bridgeport, CT

Glover Elementary School
Marblehead, MA



Norton High School
Norton, MA

Portsmouth Middle School
Portsmouth, NH



SUNY Fredonia Dods Hall Fitness Center
Fredonia, NY

Bagnall Elementary School
Groveland, MA



2012

University of Akron South Residence Hall
Akron, OH



SECTION 2

SIGNIFICANT WORK

(CONTINUED)

ACCOMPLISHMENTS

2.1 SIGNIFICANT WORK: JAMES E. LAPOSTA, JR., AIA, LEED AP

2011

Marine Science Magnet High School of Southeastern Connecticut
Groton, CT

Montaukett Learning Resource Center
Riverhead, NY

Duggan K-8 School
Waterbury, CT

Wilson Academy Restructuring Plan
Rochester, NY

2010

St. Joseph College School of Pharmacy
Hartford, CT

2009

University High School of Science and Engineering
Hartford, CT

Bishop Woods School
New Haven, CT

SUNY Fredonia Technology Incubator
Dunkirk, NY



SECTION 2

SIGNIFICANT WORK

(CONTINUED)

ACCOMPLISHMENTS

2.1 SIGNIFICANT WORK: JAMES E. LAPOSTA, JR., AIA, LEED AP

2008

Wesleyan University Center for Film Studies and Cinema Archives Phase 2
Middletown, CT

Saint Joseph University North and South Halls
West Hartford, CT

Connecticut Center for Child Development
Milford, CT

Fort Barton Elementary School
Tiverton, RI

Pocasset Elementary School
Tiverton, RI

Watkinson Center for Science and Global Studies
Hartford, CT

Crosby High School Renovations
Waterbury, CT



2007

Regional Center for the Arts
Trumbull, CT



Columbia Independent School Campus Master Plan
Columbia, MO

Barnum-Waltersville School
Bridgeport, CT



Ranger Elementary School
Tiverton, RI

Burgard Career Technical High School Program Study
Buffalo, NY



SECTION 2

SIGNIFICANT WORK
(CONTINUED)

ACCOMPLISHMENTS

2.1 SIGNIFICANT WORK: JAMES E. LAPOSTA, JR., AIA, LEED AP

2006

Haddam Killingworth Middle School
Killingworth, CT

District Wide Master Plan
Christina School District, Newark, DE

2005

Lincoln Media Arts Middle School
Meriden, CT

The Friendship School
Waterford, CT

Waterford Community Center
Waterford, CT

2004



Wesleyan University Center for Film Studies and Cinema Archives
Middletown, CT

District Wide Master Plan
Waterbury Public Schools, Waterbury CT



2003

University of Connecticut Downtown Campus
Waterbury, CT



Daniel Hand High School
Madison, CT

Hartford College for Women Master Plan
West Hartford, CT



Reed Intermediate School
Newtown, CT

SECTION 2

SIGNIFICANT WORK

(CONTINUED)

ACCOMPLISHMENTS

2.1 SIGNIFICANT WORK: JAMES E. LAPOSTA, JR., AIA, LEED AP

2002

West Woods Upper Elementary School
Farmington, CT

Webster Life Sciences Academy
San Diego, CA

Bedford Middle School
Westport, CT

Coleytown Middle School
Westport, CT

2001

Woodland Regional High School
Beacon Falls, CT

Angier Elementary School
San Diego, CA

District Wide Master Plan
Manchester Public Schools, Manchester, CT



2000

Middlesex Middle School
Darien, CT



Wintergreen Inter-district Magnet School
Hamden, CT



Hartford 2020 Plan
Hartford Public Schools, Hartford CT

Greens Farms School
Westport, CT



The Learning Corridor
Hartford, CT

SECTION 2

SIGNIFICANT WORK

(CONTINUED)

ACCOMPLISHMENTS

2.1 SIGNIFICANT WORK: JAMES E. LAPOSTA, JR., AIA, LEED AP

1999

Saxe Middle School
New Canaan, CT

Schools for the New Millennium Plan
Norwalk Public Schools, Norwalk, CT

1998

District Wide Master Plan
New Haven Public Schools, New Haven Ct

Central Elementary School
Simsbury, CT

1997

Wilbert Snow Elementary School
Middletown, CT

District Wide Master Plan
Cromwell Public Schools, Cromwell, CT

1996

Benjamin Franklin Elementary School
Meriden, CT

1995

Momauguin Elementary School
East Haven, CT

1994

Brooklyn Elementary School
Brooklyn, CT

1993

Thomas Alcorn Elementary School
Enfield, CT



SECTION 2

ACCOMPLISHMENTS

2.2 PROFESSIONAL SERVICE: JAMES E. LAPOSTA, JR., AIA, LEED AP

PROFESSIONAL SERVICE

AIA COMMITTEE ON ARCHITECTURE FOR EDUCATION (CAE)

Past Chair / Social Media Coordinator, 2009-Present

After a successful term on the CAE Leadership Group Jim has remained an active leader by established a social media presence for the CAE. He started and developed the very successful @aiacae twitter feed and has coordinated live updates from CAE events including the fall 2011 London Conference and the 2012 Seattle conference.

AIA COMMITTEE ON ARCHITECTURE FOR EDUCATION (CAE)

Chair, 2008

Jim re-established and strengthened the CAE's connection to international partners in the United Kingdom and Finland. He initiated and planned the CAE's first international conference in 8 years in Helsinki, Finland; Global Perspectives on Pedagogy and the Built Environment and initiated the restructuring of the CAE into interest-based subcommittees.

AIA COMMITTEE ON ARCHITECTURE FOR EDUCATION (CAE)

Leadership Group, 2004-2009

After many years as an active member of one of the AIA's largest Knowledge Communities Jim as asked to become a member of the Leadership (Advisory) Group in 2004 based on the quality of his body of work. During his tenure he was responsible for tripling the number of entries in the CAE Design Awards Program and was instrumental in establishing the CAE as a Knowledge Partner of the American Architectural Foundation's Great Schools by Design Program.

DESIGN YOUR HIGH SCHOOL COMPETITION (PRESENTED BY TARGET)

AMERICAN ARCHITECTURAL FOUNDATION

Northeast Regional Jury, 2009

Long Island, NY

GREAT SCHOOLS BY DESIGN, TEXAS SCHOOL DESIGN INSTITUTE

AMERICAN ARCHITECTURAL FOUNDATION

Resource Team, 2008

Austin, TX

Jim was invited as part of a resource team to assist Texas school districts in re-evaluating their approach to educational design. Working in a design charrette with educators and facility directors from a San Antonio area district his team developed a plan for a community campus in lieu of their traditional prototype school approach

KNOWLEDGE WORKS FOUNDATION

Richard W. Riley Award for Excellence

Jury member, 2007

Washington DC

SECTION 2

ACCOMPLISHMENTS

2.2 PROFESSIONAL SERVICE: JAMES E. LAPOSTA, JR., AIA, LEED AP

PROFESSIONAL SERVICE

(CONTINUED)

GREAT SCHOOLS BY DESIGN, GULF COAST SCHOOL DESIGN INSTITUTE
AMERICAN ARCHITECTURAL FOUNDATION

Resource Team, 2006

Jim was invited to share his design expertise as part of a 5 member resource team that traveled to the Mississippi gulf coast in February 2006. The team met with public officials from 18 hurricane damaged school districts to assist them in designing new and replacement facilities. The team was sponsored by the Great Schools by Design program.

NATIONAL SCHOOL DESIGN CHARRETTE
AMERICAN ARCHITECTURAL FOUNDATION

Resource Team Member, 2006

Washington DC

One of eight invited Resource Team members for the 1st National School Design Charrette; Developed a post-Katerina community campus plan with school and municipal representatives of Pass Christian MS

AIA/CAE FALL CONFERENCE; "COLLABORATION REQUIRED"

Co-Chair, 2005

Hartford/New Haven, CT

As a Co-Chair of the fall 2005 National Conference of the CAE Jim was responsible for creating and implementing a variety of programs that brought together architects, educators and state and local officials to discuss the impact that design has on learning. He developed a first of its kind program with the University of Hartford's School of Architecture to create an elective design course based on the conference topic that culminated in a studio design review using the conference attendees as jurors. Students had the unique opportunity to be exposed to architects from around the United States as they presented their designs for collaborative learning environments.

NATIONAL SUMMIT ON SCHOOL DESIGN

Invited Participant, 2005

Jim was identified as a national thought leader and was invited as part of a select group to participate in this first ever national summit sponsored by the American Architectural Foundation and the Knowledgeworks Foundation.

BOSTON SOCIETY OF ARCHITECTS K-12 DESIGN AWARDS

Juror, 2005

Jim was invited by the BSA to act a juror for this bi-annual design awards program. The results of the program as well as juror comments were published in Boston Architect Magazine.

COUNCIL OF EDUCATIONAL FACILITIES PLANNERS INTERNATIONAL
NATIONAL SCHOOL CONSTRUCTION WEEK

Juror ,2005

Washington, DC

This annual event allows high school students the opportunity to design their ideal school and then present the project to a panel of national experts in design and planning.

SECTION 2

ACCOMPLISHMENTS

2.2 PROFESSIONAL SERVICE: JAMES E. LAPOSTA, JR., AIA, LEED AP

PROFESSIONAL SERVICE

(CONTINUED)

AIA/CAE EXEMPLARY LEARNING ENVIRONMENTS COMPETITION

Jury Chair, 2004

As Chair of the 2004 CAE Design Awards Program Jim was responsible for tripling the number of entries. As a juror and member of the CAE Leadership Group he was instrumental in keeping the focus of this program on the quality of design. In the spring of 2005 he presented the awards at a gathering at the Finnish Embassy in Washington, DC.

SCHOOL DESIGN FORUM

Resource Team, 2004

Washington, DC

This forum gathered teachers from all over the United States in a day-long workshop session to explore the design of learning environments. Jim was a Resource Team member and facilitator

AIA/CAE EXEMPLARY LEARNING ENVIRONMENTS COMPETITION

Juror, 2003

AIA/NATIONAL SCHOOL BOARDS ASSOCIATION LEARNING BY DESIGN COMPETITION

Juror, 2000

AMERICAN SCHOOL AND UNIVERSITY MAGAZINE DESIGN COMPETITION

Juror, 2003

UNIVERSITY OF HARTFORD SCHOOL OF ARCHITECTURE

Visiting Critic, Various Studios; 2002-2005

UNIVERSITY OF MASSACHUSETTS, AMHERST

SCHOOL OF FINE ARTS

Visiting Critic, 1993-95

AIA CONNECTICUT DESIGN COMMISSION

DESIGN AWARDS SUBCOMMITTEE

Member, 1989-1993

YALE UNIVERSITY SCHOOL OF ARCHITECTURE

External Thesis Advisor, 1999

Conversion of a "dead mall" into a learning environment.

SECTION 2

DESIGN AWARDS



“A wonderful transformation through a strong reconfiguration of the site plan, with clear, well executed concepts of connecting inside and outdoors. The shed roof corridor of wood and steel is very strong feature, a metaphor for the woodsy landscape. The new addition with its camp like atmosphere completely transforms the existing school, making it open, airy, light, inviting and a good place for learning.”

**AIA CT Design Awards Jury
Comments; Wilbert Snow School**

ACCOMPLISHMENTS

2.3 DESIGN AWARDS: JAMES E. LAPOSTA, JR., AIA, LEED AP

Jim was directly responsible for the design of the projects listed below;

AIA CHAPTER AWARDS

AIA Connecticut Design Award 2008

Regional Center for the Arts
Trumbull, CT

AIA Connecticut Design Award 2004

Wesleyan Center for Film Studies and Cinema Archive
Middletown, CT

AIA Connecticut Design Award 2004

University of Connecticut Waterbury Campus
Waterbury, CT

AIA Connecticut Design Award 2001

Wilbert Snow Elementary School
Middletown, CT

AIA NATIONAL AWARDS

AIA / CAE Design Citation 1999

Wilbert Snow Elementary School
Middletown, CT

AIA / CAE Design Award 1999

Benjamin Franklin Elementary School
Meriden, CT

AIA / CAE Design Award 1999

Bedford Middle School
Westport, CT

SECTION 2

DESIGN AWARDS

(CONTINUED)



"It gives a sense of place and identity to an entire campus that was previously lacking," the judges said, noting that the entrance, which is on the main axis of the campus, is a striking focal point. "It creates a magnet for the students," one judge said. "It looks like a place where people want to be."

**Learning by Design Jury;
Montaukett Learning
Resource Center**

ACCOMPLISHMENTS

2.3 DESIGN AWARDS: JAMES E. LAPOSTA, JR., AIA, LEED AP

REGIONAL AWARDS

Learning by Design Honorable Mention 2012

Montaukett Learning Resource Center
Riverhead, NY

Real Estate Exchange; 2012 Best in Class, Educational Category

Marine Science Magnet High School of Southeastern CT
Groton, CT

Learning By Design Honorable Mention 2011

University High School of Science and Engineering
Hartford, CT

Learning By Design Honorable Mention 2009

Regional Center for the Arts
Trumbull, CT

American School & University Citation Award 2007

Wesleyan Center for Film Studies and Cinema Archives
Middletown, CT

American Association of School Administrators (AASA) Citation Honoree 2004

Daniel Hand High School
Madison, CT

National School Boards Association (NSBA) Citation of Excellence 2004

Daniel Hand High School
Madison, CT

American School and University Citation Award 2004

Daniel Hand High School,
Madison, CT

Association of School Business Officials (ASBO) International Certificate of Excellence 2004

Daniel Hand High School
Madison, CT

Council of Educational Facilities Planners International James D. MacConnell Award Finalist 2003

West Woods Upper Elementary School
Farmington, CT

American School & University Elementary School Citation 2003

West Woods Upper Elementary School
Farmington, CT

SECTION 2

DESIGN AWARDS

(CONTINUED)



“Cluster plan breaks scale down to elementary-age children. Spaces for small-group and project work show attention to research. Building materials are warm and inviting.”

**AS&U Jury;
West Woods
Upper Elementary School**

ACCOMPLISHMENTS

2.3 DESIGN AWARDS: JAMES E. LAPOSTA, JR., AIA, LEED AP

DesignShare Awards for Innovative Schools Recognized Value Award 2003

West Woods Upper Elementary School
Farmington, CT

American Association of School Administrators (AASA) Citation Honoree 2003

West Woods Upper Elementary School
Farmington, CT

National School Boards Association (NSBA) Citation Honors 2003

West Woods Upper Elementary School
Farmington, CT

Association of School Business Officials (ASBO) International Citation Honoree 2003

Suffield High School
Suffield, CT

DesignShare Awards for Innovative Schools Citation Award 2002

Woodland Regional High School
Beacon Falls, CT

American Association of School Administrators (AASA) Citation Honors 2002

Woodland Regional High School
Beacon Falls, CT

NSBA Learning by Design Grand Prize 2002

Woodland Regional High School
Beacon Falls, CT

National School Boards Association (NSBA) Design Citation 2001

Wintergreen Interdistrict Magnet School
Hamden, CT

American School and University, Gold Citation 2001

Wintergreen Interdistrict Magnet School
Hamden, CT

National School Boards Association (NSBA) Design Citation 2000

Bedford Middle School
Westport, CT

National School Boards Association (NSBA) Citation for Excellence 2000

Benjamin Franklin Elementary School
Meriden, CT

SECTION 2

ACCOMPLISHMENTS

2.3 DESIGN AWARDS: JAMES E. LAPOSTA, JR., AIA, LEED AP

DESIGN AWARDS

(CONTINUED)



“The jury liked the curved wall of this magnet school, the curve of graceful entry and the way the curve was used to open up spaces to the outside. The jury also like the way the building was perched lightly on the landscape, with its sense of the rural setting and the way it brought in natural light.”

**AIA CT Design Awards Jury;
Regional Center for the Arts**

American Association of School Administrators (AASA) Citation Honoree 2000

Saxe Middle School

New Canaan, CT

National School Boards Association (NSBA) Citation Award 2000

Saxe Middle School

New Canaan, CT

DesignShare Awards for Innovative Schools Merit Award 2000

Bedford Middle School

Westport, CT

American School and University, Crow Island School Citation 2000

Saxe Middle School

New Canaan, CT

American School and University Middle School Citation 2000

Saxe Middle School

New Canaan, CT

NSBA Learning By Design Citation 2000

Saxe Middle School

New Canaan, CT

American Association of School Administrators (AASA) Citation for Design 1999

Wilbert Snow Elementary School

Middletown, CT

DesignShare Awards for Innovative Schools Recognized Value Award 1999

Middlesex Middle School

Darien, CT

Council of Educational Facilities Planners International Citation for Excellence 2000

Saxe Middle School

New Canaan, CT

DesignShare Awards for Innovative Schools Merit Award 1999

Saxe Middle School

New Canaan, CT

American School and University, Crow Island School Citation 1999

Wilbert Snow Elementary School

Middletown, CT

SECTION 2

LECTURES AND PRESENTATIONS

ACCOMPLISHMENTS

2.4 LECTURES AND PRESENTATIONS BY: JAMES E. LAPOSTA, JR., AIA, LEED AP

Investing in Education; Building Better Schools; What We Learned from London

AIA National Convention 2012

Washington, DC

Community Engagement in School Design

National School Boards Association National Conference 2011

San Francisco, CA

British Council on School Environments

Study Tour

New York, NY 2011

Blurring the Boundaries; University HS of Science and Engineering

Society of College and University Planners National Convention 2010

Minneapolis, MN

Design of the Learning Environment as a Tool for School Reform

College Board Annual Leadership Colloquium 2010

Tampa, FL

University High School of Science and Engineering

SCUP North Atlantic Regional Meeting 2010

Cambridge, MA

AIA / CAE Educational Facilities Study Tour

AIA National Convention 2009

San Francisco, CA

Blurring the Boundaries; University HS of Science and Engineering

School Building Expo / CAE Spring Meeting 2009

Pittsburgh PA

Schools in a Flat World; Connecting to a Global Design Pedagogy

CEFPI World Conference 2009

Washington DC

Shades of Green; Trends in Sustainable School Design

Magnet Schools of America Spring Conference 2009

Mystic CT

Sustainable Schools

AIA Charlotte Annual Conference 2009

Charlotte, NC

SECTION 2

LECTURES AND PRESENTATIONS

(CONTINUED)

ACCOMPLISHMENTS

2.4 LECTURES AND PRESENTATIONS BY: JAMES E. LAPOSTA, JR., AIA, LEED AP

Planning and Designing 21st Century Learning Environments

Center for Architecture 2009
New York, NY

Building Community Schools

Center for Architecture 2008
New York, NY

Trends in US School Design

V/S America Days 2007
Tauberbischofsheim Germany

Gulf Coast Design Institute presentation

AIA National Convention 2007
San Antonio TX

Urban School Design

Association of School Business Officers International Meeting 2006
Pittsburgh, PA

Report from the Gulf Coast

AIA/CAE Spring Conference 2006
Cincinnati, OH

AIA Committee on Architecture for Education / Open Forum Discussion Leader

AIA National Convention 2006
Los Angeles, CA

The Learning Corridor; Design Overview

AIA/CAE Fall Conference 2005
Hartford, CT

New Trends in School Design

National School Boards Association National Conference 2005
San Diego, CA

AIA/CAE Design Awards Presentation / Trends in School Design

AIA/CAE/Grassroots Spring Conference 2005
Washington, DC

Case Study; Wesleyan Center for Film Studies

Construction Institute Annual Meeting 2005
Hartford, CT

SECTION 2

LECTURES AND PRESENTATIONS

(CONTINUED)

ACCOMPLISHMENTS

2.4 LECTURES AND PRESENTATIONS BY: JAMES E. LAPOSTA, JR., AIA, LEED AP

State of the State; Design Trends in Education

Real Estate Exchange 2005

Hartford, CT

New Wine in Old Bottles

Council for Education Facilities Planners International 2005

San Antonio, TX

Change in the South End; A Hartford Case Study

AIA/CAE Urban and Innovative Schools Conference 2003

Minneapolis, MN

Why is Change So Hard? Pre conference Workshop

Council for Education Facilities Planners International 2003

Chicago, IL

New Trends in Urban School Design

New England School Development Council 2003

Sturbridge, MA 2003

National Trends in New School Design

CABE/CAPSS Annual Convention 2003

Waterbury, CT

Renovation Case Studies; Design Possibilities

New England School Development Council 2002

Sturbridge, MA

Woodland High School Case Study

State of Connecticut School Facilities Conference 2002

Farmington, CT

New Urban Schools

New Haven Urban Design League 2002

New Haven, CT

Wilbert Snow School Case Study

Outreach Community Center for Urban Research 2000

California State Polytechnic University Pomona

SECTION 2

PUBLICATIONS

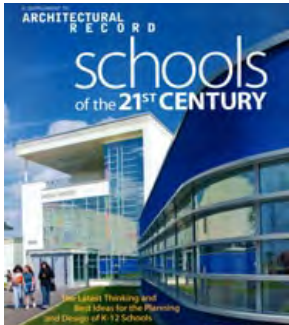

“Just as Wheeler cites JCJ’s on-site presence as a reason for the building’s success, LaPosta praises Wheeler’s involvement in the design process. “One of the things she said to us was that it was all about the kids.” Wheeler ... gives the building high marks. JCJ’s thorough research made all the difference, she says. The firm “really did resolve all of the challenges that we presented. They obviously heard us.”

Architectural Record
January 2009

ACCOMPLISHMENTS

2.5 PUBLICATIONS: JAMES E. LAPOSTA, JR., AIA, LEED AP

NATIONAL PUBLICATIONS

Green Source Magazine

“At the Watkinson School, a pre-engineered building blends environmental science with ethics”

by David Sokol

January 2012

Architectural Record; Schools of the 21st Century

“Creative Community; Regional Center for the Arts” by Sebastian Howard

January 2009

AIA Architect

“The User’s Guide: Education—Where They’re Designing and Building Schools and Why” by Zach Mortice

March 20, 2009

Variety

“Film Center fulfills Basinger’s Mission” by Lael Loewenstein

May 27, 2008

Architectural Record

“Community Campus Plan; Pass Christian School District, Pass Christian, Mississippi”

by Charles Linn FAIA

January 2007

New York Times

“Film; Now Playing at Wesleyan” by Avi Salzman

May 22, 2005

Architectural Record Review

“Wilbert Snow Elementary School Revisited” by Jane Merkel

November 2004

Architectural Record Review

“Trends in School Design” by Jayne Merkel

West Woods Upper Elementary School and Alcorn Elementary School

November 2004

New York Times

“Schools Start but Mold Got There First” by Stacey Stowe

(Jim was interviewed as an expert in school design)

September 7, 2003

Architectural Record

Saxe Middle School; A Cramped and Aging School is Updated for the 21st Century Building Types Study November 2000

Architectural Record

“Wilbert Snow Elementary School” by William Weathersby

November 1999

SECTION 2

PUBLICATIONS

(CONTINUED)



"I get so much more accomplished now than I did before. I don't think I'll ever forget the day that we first walked into the new school. The children felt important. The teachers felt important."

Teacher Christine Salamone
excerpted from
Post-Occupancy 2003;
Wilbert Snow School;
Architectural Record
November 2003

ACCOMPLISHMENTS

2.5 PUBLICATIONS: JAMES E. LAPOSTA, JR., AIA, LEED AP

SPECIALITY PUBLICATIONS

Expeditionary Learning Evidence of Engagement Blog

"Architecture for a Different Type of Learning"

by James E. LaPosta Jr AIA LEED AP

September 2012

District Administrator Magazine

"Give Wood a Chance" (Interview regarding innovative uses of wood in school design and construction)

by Marion Herbert

October 2012

Construction Today

"The Space Between; Rethinking Classroom Design"

by James E. LaPosta Jr AIA LEED AP

June 2012

District Administrator Magazine

"New Conn. Magnet School Commands Aquatic Culture"

by Marion Herbert

April 2012

American Libraries

"New and Now; 2012 Library Design Showcase"

by Greg Landgraf

March/April 2012

ENR New York

"Cautiously Optimistic; Design Industry Sees Signs of Recovery, but Challenges Remain"

by Alex Padalka

October 1, 2010

e-Oculus; Reports from the Field

"School Design Trends; Bringing the Outdoors In Regional Center for the Arts"

by Shana Smith

April 2009

Wesleyan Argus

"Architects Praise New Film Center"

by Izaak Orlansk

October 22, 2004

DesignShare

An interactive forum on innovative alternatives in learning environments; Amsterdam Watershed

by Randall Fielding

January 2001

SECTION 2

PUBLICATIONS

(CONTINUED)

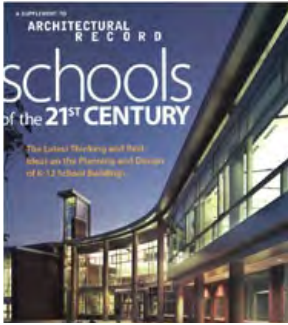

“The opportunity provided by the massive rebuilding of Pass Christian following Hurricane Katrina led the team to a discussion of the number and type of community buildings that were to be replaced. The team quickly agreed that while plans to build the school should be retained, the best way to resolve the budget issues was to combine other facilities on the site to create a community complex with “critical mass.” Such a place would become a symbol of the town’s rebirth, leverage funding, and free other land for expanded facilities elsewhere.”

Excerpted from “Community Campus Plan” Architectural Record; Schools of the 21st Century January 2007

ACCOMPLISHMENTS

2.5 PUBLICATIONS: JAMES E. LAPOSTA, JR., AIA, LEED AP

BOOKS

Evidence Based Design; A Responsive Approach to Creating Learning Environments

by Peter C. Lippman; John Wiley & Sons 2010,

Regional Center for the Arts, West Woods Upper Elementary School, Kolnaski Elementary School

International Educational Spaces 3

Woodland Regional High School

Images Press 2003

International Educational Spaces 3

Wilbert Snow Elementary School (feature and cover)

Images Press 2003

AIA Exemplary Learning Environments Program; Educational Facilities

Wilbert Snow Elementary School

Images Press 2002

AIA Exemplary Learning Environments Program; Educational Facilities

Bedford Middle School

Images Press 2002

AIA Exemplary Learning Environments Program; Educational Facilities

Benjamin Franklin Elementary School

Images Press 2002

Class Architecture

by Michael Crosby; Images Press 2001

Wilbert Snow Elementary School

Class Architecture

by Michael Crosby; Images Press 2001

Saxe Middle School

Class Architecture

by Michael Crosby; Images Press 2001

Wintergreen Inter-district Magnet School

Building Type Basics for Elementary and Secondary Schools

by Bradford Perkins; John Wiley & Sons, 2001

Wilbert Snow Elementary School

SECTION 3

EXHIBITS

JAMES E. LAPOSTA, JR., AIA, LEED AP

- 01 WILBERT SNOW ELEMENTARY SCHOOL**
Middletown, Connecticut
- 02 REGIONAL CENTER FOR THE ARTS**
Trumbull, Connecticut
- 03 WESLEYAN CENTER FOR FILM STUDIES AND CINEMA ARCHIVES**
Wesleyan University
Middletown, Connecticut
- 04 MONTAUKETT LEARNING RESOURCE CENTER**
Suffolk County Community College
Riverhead, New York
- 05 MARINE MAGNET HIGH SCHOOL OF SOUTHEASTERN CONNECTICUT**
New London, Connecticut
- 06 SAXE MIDDLE SCHOOL**
New Canaan, Connecticut
- 07 WOODLAND REGIONAL HIGH SCHOOL**
Regional School District #16, Beacon Falls/Prospect, Connecticut
- 08 UNIVERSITY HIGH SCHOOL OF SCIENCE AND ENGINEERING**
Hartford, Connecticut
- 09 PORTSMOUTH MIDDLE SCHOOL**
Portsmouth, New Hampshire
- 10 WORLD OF INQUIRY SCHOOL NO 58**
Rochester, New York

SECTION 3

EXHIBITS
EXHIBIT 01

WILBERT SNOW ELEMENTARY SCHOOL
MIDDLETOWN PUBLIC SCHOOLS | MIDDLETOWN, CONNECTICUT

RELEVANCE

At the Wilbert Snow School Jim created a learning environment seamlessly integrated with its site and community. Focused on the needs of young children the school broke down traditional elementary school planning models and offered small learning communities connected by single loaded corridors open to views of the woodland site. Since its opening, the schools planning and design story has been shared at national conferences and in numerous architectural books, periodicals, and websites.



NESTLED IN A THICKLY WOODED SITE

The original Wilbert Snow Elementary School was designed and opened in 1954 with a California-style campus composed of single grade level buildings set into the property and distant from core spaces such as cafeteria, auditorium, gymnasium and administration. The program undertaken by Jim LaPosta was to modernize the school's campus, to bring students into a singular and continuous structure and to link together all core areas, which would remain largely untouched.

The building abuts a city park and straddles the path of a revolutionary war era roadway. JCJ's school design embraces and embodies the historical significance of the site and is configured so as to provide views and interaction with the surrounding parklands. The school integrates indoor and outdoor learning environments – seamlessly. Totalling 71,000 square feet, the renovation/expansion project serves 550 PreK - Grade 5 students.

DECLARATION OF RESPONSIBILITY

I have personal knowledge of the nominee's responsibility for the project listed above. That responsibility included:

principally responsible for design

David G. Jepson, FAIA
Chairman, JCJ Architecture

ARCHITECTURE FIRM OF RECORD/DESIGN FIRM JCJ Architecture
COMPLETION DATE 1998
ROLE OF NOMINEE Principal-in-Charge, Design Principal

SECTION 3

EXHIBITS EXHIBIT 01

WILBERT SNOW ELEMENTARY SCHOOL

AWARDS

AIA Connecticut Design Award
2001

AIA / CAE Design Citation 1999

American Association of School
Administrators (AASA) Citation for
Design 1999

American School and University,
Crow Island School Citation 1999

LECTURES

Wilbert Snow School Case Study
Outreach Community Center for
Urban Research 2000
California State Polytechnic
University Pomona





PUBLICATIONS
Architectural Record Review
 "Wilbert Snow Elementary School Revisited" by Jane Merkel
 November 2004

Architectural Record
 "Wilbert Snow Elementary School" by William Weathersby
 November 1999

AIA Exemplary Learning Environments Program; Educational Facilities
 Wilbert Snow Elementary School
 Images Press 2002

Class Architecture
 By Michael Crosby; Images Press
 2001

Wilbert Snow Elementary School Building Type Basics for Elementary and Secondary Schools
 by Bradford Perkins; John Wiley & Sons, 2001

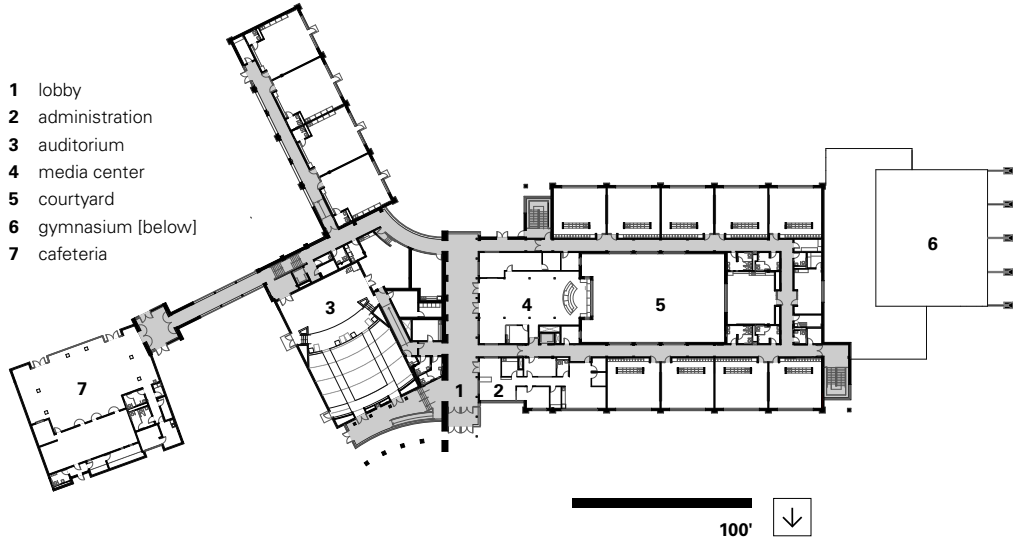

SECTION 3

EXHIBITS
EXHIBIT 02

REGIONAL CENTER FOR THE ARTS
COOPERATIVE EDUCATIONAL SERVICES | TRUMBULL, CONNECTICUT

RELEVANCE

The design of the RCA began with the school Principal’s statement that “it’s all about the kids”. Jim led a programming and design effort highlighted by an intensive immersion in the daily life of the school. That experience sitting in classes and talking to students led to a plan that focused the life of the school on a curved commons that serves as a student lounge, theater lobby, and informal learning space. A feeling of transparency and community bind the school together in a way that encourages consistent and positive adult and student interactions.



CREATE A PROFESSIONAL-LEVEL FACILITY FOR HIGH SCHOOL STUDENTS

The Regional Center for the Arts is a performing arts magnet school with a student capacity of 250 that serves sixteen area municipalities. The new 41,000 square foot facility contains instructional and performance spaces for the production of dance, musical theater, drama, and music. The majority of the teaching staff are members of the nearby NYC theater and arts community

The building is comprised of individual “pods” which are devoted to specific educational programs and was designed to promote a feeling of community. Located along the ridge of the site, the pods break the scale of the building, while the design scheme addresses the residential fabric of the neighborhood along with the energy and vitality of the programs being offered. The crescent-shaped, north-facing entry elevation is finished almost entirely in low-emissivity glass, which welcomes daylight but mitigates heat gain.

DECLARATION OF RESPONSIBILITY

I have personal knowledge of the nominee’s responsibility for the project listed above. That responsibility included:

principally responsible for design



David G. Jepson, FAIA
Chairman, JCJ Architecture

ARCHITECTURE FIRM OF RECORD/DESIGN FIRM JCJ Architecture
COMPLETION DATE 2007
ROLE OF NOMINEE Principal-in-Charge, Design Principal

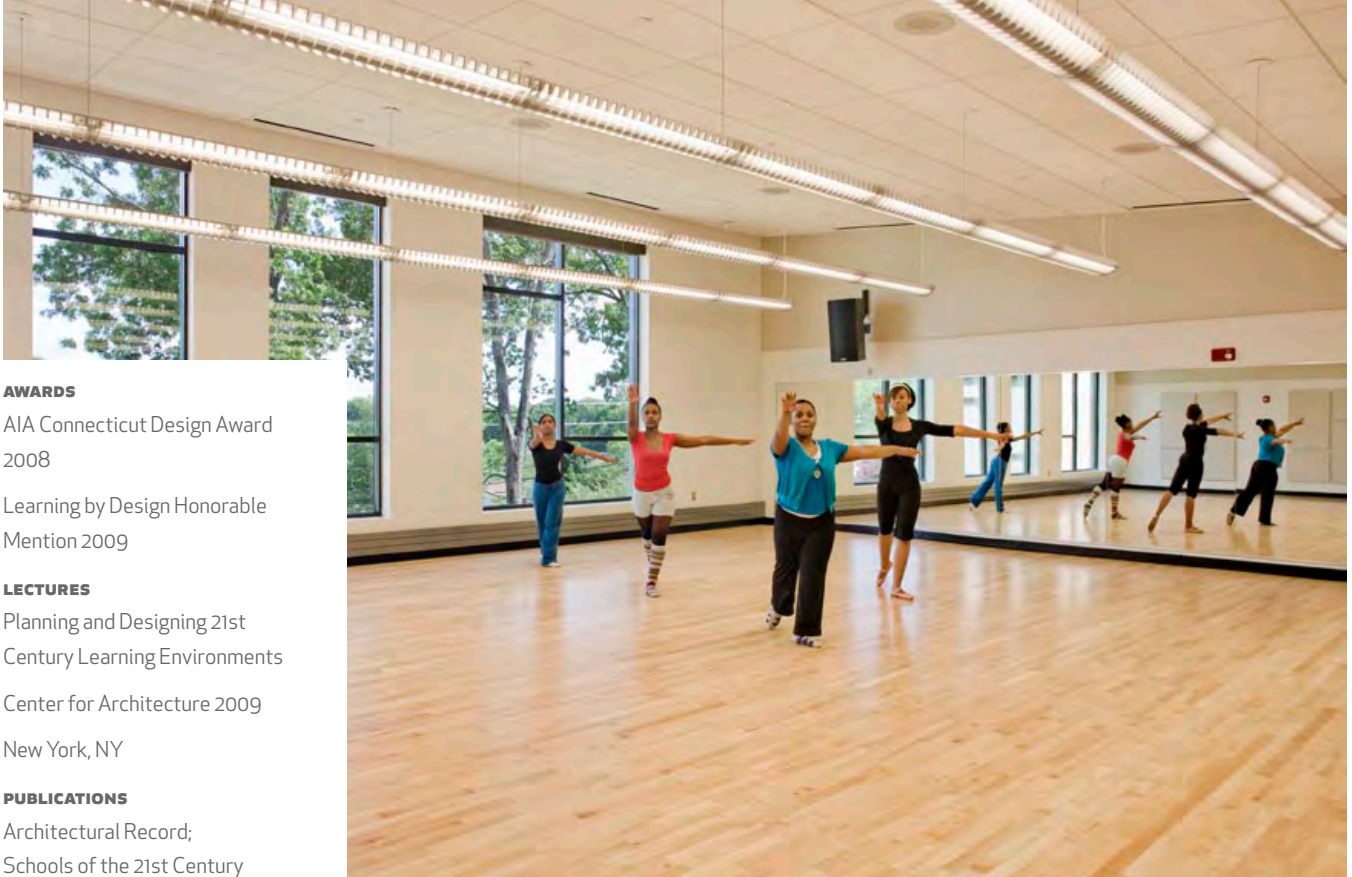

AWARDS

AIA Connecticut Design Award
2008

Learning by Design Honorable
Mention 2009

LECTURES

Planning and Designing 21st
Century Learning Environments
Center for Architecture 2009
New York, NY

PUBLICATIONS

Architectural Record;
Schools of the 21st Century

"Creative Community;
Regional Center for the Arts"
by Sebastian Howard
January 2009

e-Oculus; Reports from the Field
"School Design Trends; Bringing
the Outdoors In Regional Center
for the Arts" by Shana Smith
April 2009

Evidence Based Design;
A Responsive Approach to
Creating Learning Environments
by Peter C. Lippman;
John Wiley & Sons 2010



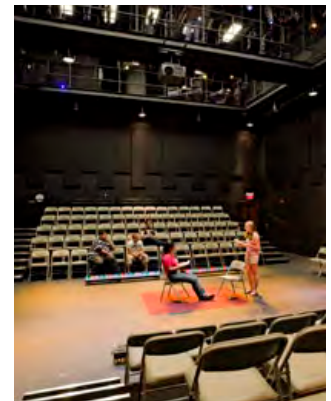
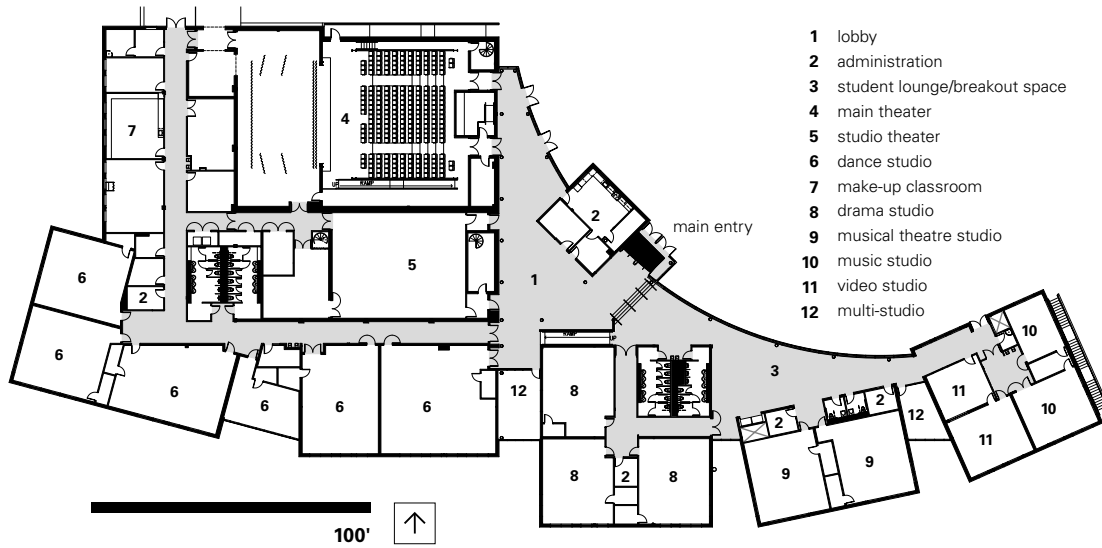

SECTION 3

EXHIBITS
EXHIBIT 03

CENTER FOR FILM STUDIES AND CINEMA ARCHIVES
WESLEYAN UNIVERSITY | MIDDLETOWN, CONNECTICUT

RELEVANCE

Jim’s commitment to spaces that encourage a sense of community and promote the serendipitous encounter is evident in the design of the Center for Film Studies. Every room opens to the wintegarden, a transparent space that accommodates group learning, solitary reflection, and community celebration.



USE LIGHT - THE FILM MAKERS MEDIUM - TO SHAPE SPACE

Capitalizing on a central theme of light in motion, Jim LaPosta married the program’s traditional, existing building with modern design to create a 26,000 square foot facility for the study of film and preservation of film-related artifacts. Located on a transitional site between the University and a residential historic district, the new light-filled center consolidates program resources. The new facility provides spaces for film theory and history; and presentation and production of 16mm film, digital video, and virtual film. Placement of the 400-seat theatre at an angle behind the current archives diminishes its size and scale, while brick and limestone materials were chosen for their compatibility with the neighborhood. An enclosed atrium serves as an informal gathering space between the Center and Cinema Archives.

DECLARATION OF RESPONSIBILITY

I have personal knowledge of the nominee’s responsibility for the project listed above. That responsibility included:

principally responsible for design

David G. Jepson, FAIA
Chairman, JCJ Architecture

ARCHITECTURE FIRM OF RECORD/DESIGN FIRM JCJ Architecture

COMPLETION DATE 2004 (phase 1), 2007 (phase 2)

ROLE OF NOMINEE Principal-in-Charge, Design Principal



AWARDS

AIA Connecticut Design Award
2004

American School & University
Citation Award 2007

LECTURES

Case Study; Wesleyan Center
for Film Studies

Construction Institute Annual
Meeting 2005

PUBLICATIONS

Variety
"Film Center fulfills Basinger's Mission"
by Lael Loewenstein
May 27, 2008

New York Times
"Film; Now Playing at Wesleyan" by Avi Salzman
May 22, 2005

Wesleyan Argus
"Architects Praise New Film Center" by Izaak Orlansk
October 22, 2004

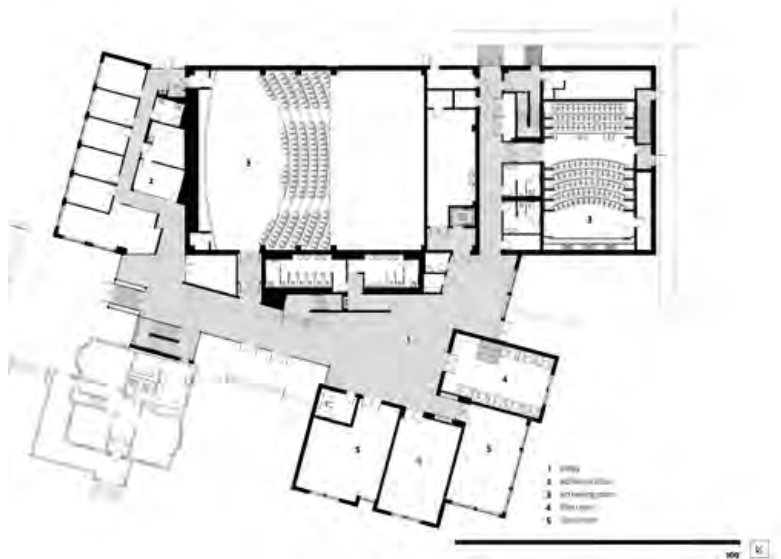
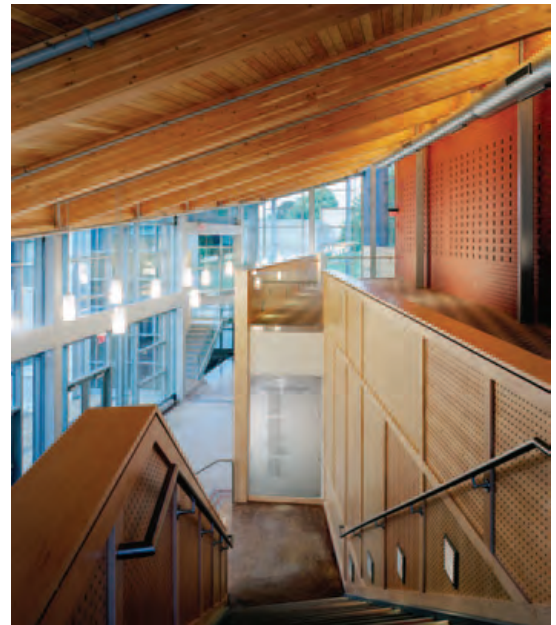

SECTION 3

EXHIBITS
EXHIBIT 04

MONTAUKETT LEARNING RESOURCE CENTER
SUFFOLK COUNTY COMMUNITY COLLEGE | RIVERHEAD, NEW YORK

RELEVANCE

Jim’s sensitivity to creating places of gathering is evident in the new Montaukett Learning resource Center. Originally proposed for a remote location, Jim convinced the college to locate the new building in the center of the campus to complete a quadrangle with the existing buildings and provide the ability to create a second quad with future construction. As a commuter campus it was important to create a strong sense of place and a building that welcomes students at all hours of the day and night. Popular with students since opening, the wide mix of learning and social environments in the building have encouraged more on-campus activity. It is the campus’ first LEED Gold building.



DEFINE THE HEART OF THE SUFFOLK COUNTY CAMPUS

The Jim LaPosta designed Learning Resource Center meets all the Owner’s goals to create a centralized hub for study, literacy, meeting and reseach; to create a cohesive new identity for the community college campus; and to define a new and clear aesthetic direction for future campus expansions. Jim took inspiration from simple elements that were consistent on existing campus buildings - engaged exterior columns, horizontal banding within the brick - and created a feature element by inverting a traditional gable roof form to create a dramatic centerpiece for the campus.

Sustainability has incorporated in the design, integrating geothermal heating and cooling, recycled rainwater, sun screening devices, and sustainable interior elements to ensure a green building within the allocated budget. The project is anticipated to achieve LEED Gold certification.

DECLARATION OF RESPONSIBILITY

I have personal knowledge of the nominee’s responsibility for the project listed above. That responsibility included:

principally responsible for design

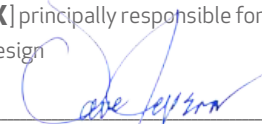

David G. Jepson, FAIA
Chairman, JCJ Architecture

ARCHITECTURE FIRM OF RECORD/DESIGN FIRM JCJ Architecture
COMPLETION DATE 2011
ROLE OF NOMINEE Principal-in-Charge, Design Principal



AWARDS

Learning by Design
Honorable Mention
2012

PUBLICATIONS

American Libraries
"New and Now; 2012 Library
Design Showcase"
by Greg Landgraf
March/April 2012



**MARINE SCIENCE MAGNET HIGH SCHOOL
OF SOUTHEASTERN CONNECTICUT**

**EXHIBITS
EXHIBIT 05**

LEARN REGIONAL EDUCATIONAL COOPERATIVE | NEW LONDON, CONNECTICUT

SECTION 3

RELEVANCE

Jim collaborated with educators and community partners in a 10 town region to develop a building in support of a unique educational program. Focused on “the space between”, the building turns traditional school models inside-out and limits the amount of closed classroom space in favor of an open and transparent student home base. The seamless integration of space, furniture, and technology in a student centered environment has been shared in numerous publications and conferences since its recent opening.



DESIGN TO REFLECT HANDS-ON LEARNING AND A COASTAL SITE

Jim’s approach to this unique educational facility was to create a design that reflects the curriculum, goals and location in this Connecticut coastal city. The school’s design thus reflects a marine science educational theme and the client’s mission of preparing students for marine-related employment and higher education, and to equip students with both practical skills and theoretical knowledge through the field study of the fresh and salt water features.

The building’s small footprint respects the natural environment by disturbing as little of the site as necessary. The design treats the students as “apprentice researchers,” and connects students to the site’s fresh water pond and salt water creek. The labs and classrooms have visual and physical links to the site, integrating classroom work, laboratory experimentation and the real physical environment. Pedestrian friendly outdoor learning environments provide spaces for active learning in the environment.

DECLARATION OF RESPONSIBILITY

I have personal knowledge of the nominee’s responsibility for the project listed above. That responsibility included:

principally responsible for design

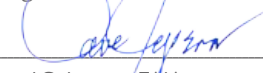

David G. Jepson, FAIA
Chairman, JCJ Architecture

ARCHITECTURE FIRM OF RECORD/DESIGN FIRM JCJ Architecture
COMPLETION DATE 2011
ROLE OF NOMINEE Principal-in-Charge, Design Principal

SECTION 3

EXHIBITS
EXHIBIT 05

**MARINE SCIENCE MAGNET HIGH SCHOOL
OF SOUTHEASTERN CONNECTICUT**



AWARDS

Real Estate Exchange; 2012 Best in Class, Educational Category

LECTURES

Design of the Learning Environment as a Tool for School Reform
College Board Annual Leadership Colloquium 2010

Magnet Schools of America Annual Conference Austin, TX
"Our Rodeo of Exploration: From Fish Nets to Simulators"

PUBLICATIONS

Construction Today
"The Space Between; Rethinking Classroom Design"
By James E. LaPosta Jr AIA
June 2012

District Administrator Magazine
"New Conn. Magnet School Commands Aquatic Culture" by Marion Herbert, April 2012

WFSB, Channel 3
Hartford, CT
Cool Schools - Prime Time Feature



SECTION 3

EXHIBITS EXHIBIT 06

SAXE MIDDLE SCHOOL NEW CANAAN PUBLIC SCHOOLS | NEW CANAAN, CONNECTICUT

RELEVANCE

Saxe represents Jim's ability to work with educators to reinvent older facilities in support of new ways of teaching and learning. Originally designed as an "industrial model" high school, Jim led the design effort to strategically add to the school to not only solve capacity concerns but to transform it into a team-teaching middle school. Its new visual identity and small learning community plan have been published widely and cited as a model for renovation and addition projects.



ADAPT TO THE NEEDS OF MIDDLE SCHOOL TEAMING

Jim's design for Saxe Middle School took a 1950s-era junior high school and redesigned it to accommodate a 1200 student team teaching environment. Common areas are the key elements in adapting this departmental model school to the needs of middle school teaming. New and existing learning areas are organized into teams and connected by a variety of usable common areas. Outside the cafeteria, a large, day-lit student commons provides areas for events and large gatherings that are more informal in nature. The more informal setting characterizes the focus of middle school education. Breakout areas provide casual, yet supervised settings for small group work, informal conferencing, and special events. Each of these areas has built-in window seats, data and video connections, and a whiteboard. Large public spaces provide room for other types of teaming.

DECLARATION OF RESPONSIBILITY

I have personal knowledge of the nominee's responsibility for the project listed above. That responsibility included:

principally responsible for design

David G. Jepson, FAIA
Chairman, JCJ Architecture

ARCHITECTURE FIRM OF RECORD/DESIGN FIRM JCJ Architecture

COMPLETION DATE 1999

ROLE OF NOMINEE Principal-in-Charge, Design Principal

**AWARDS**

American Association of School Administrators (AASA) Citation Honoree 2000

National School Boards Association (NSBA) Citation Award 2000

American School and University, Crow Island School Citation 2000

American School and University Middle School Citation 2000

NSBA Learning By Design Citation 2000

Council of Educational Facilities Planners International Citation for Excellence 2000

DesignShare Awards for Innovative Schools Merit Award 1999

LECTURES

New Wine in Old Bottles
Council for Education Facilities Planners International 2005
San Antonio, TX

National Trends in New School Design
CABE/CAPSS Annual Convention 2003
Waterbury, CT

Renovation Case Studies;
Design Possibilities
New England School Development Council 2002
Sturbridge, MA

PUBLICATIONS

Architectural Record
Saxe Middle School; A Cramped and Aging School is Updated for the 21st Century
Building Types Study November 2000

Class Architecture
By Michael Crosby; Images Press 2001
Saxe Middle School



SECTION 3

EXHIBITS
EXHIBIT 07

WOODLAND REGIONAL HIGH SCHOOL
REGIONAL SCHOOL DISTRICT #16 | BEACON FALLS/PROSPECT, CONNECTICUT

RELEVANCE

As with many of his projects, Woodland HS is indicative of Jim’s ability to bring communities together to build schools that look to the future. He led a successful public process to design and gain voter approval for a regional school district’s first high school; a task made more difficult by the fact that the two towns comprising the region did not share a common border. The school was developed around a unique “learning studio” configuration; a combination of full and half-sized classrooms connected by doors and movable partitions that allow for a wide variety of curriculum delivery.



DEFINE A REGIONAL CENTER FOR TWO RURAL COMMUNITIES

This new 800 student high school provides a regional center for two towns that share no common border. Jim designed an entry plaza to become a “town square” that would connect the student population with one another and the outdoors. Academic, arts, and athletic pavilions are organized around the courtyard, which also serves as an outdoor lobby for arts, sports educational and civic events for the two communities. Sports, entertainment and educational centers are each designed as individual communities so that areas can be isolated during and after, school hours.

Extremely steep topography required a terraced building with large stairs kept open to promote interaction, ease of supervision, and outdoor learning areas. The region’s vernacular mill buildings inspire this school’s distinctive form and details.

DECLARATION OF RESPONSIBILITY

I have personal knowledge of the nominee’s responsibility for the project listed above. That responsibility included:

principally responsible for design



David G. Jepson, FAIA
Chairman, JCJ Architecture

ARCHITECTURE FIRM OF RECORD/DESIGN FIRM JCJ Architecture
COMPLETION DATE 2001
ROLE OF NOMINEE Principal-in-Charge, Design Principal



AWARDS

DesignShare Awards for Innovative Schools Citation Award 2002

American Association of School Administrators (AASA) Citation Honors 2002

NSBA Learning by Design Grand Prize 2002

LECTURES

Woodland High School Case Study
State of Connecticut School Facilities Conference 2002
Farmington, CT

PUBLICATIONS

International Educational Spaces 3
Woodland Regional High School
Images Press 2003

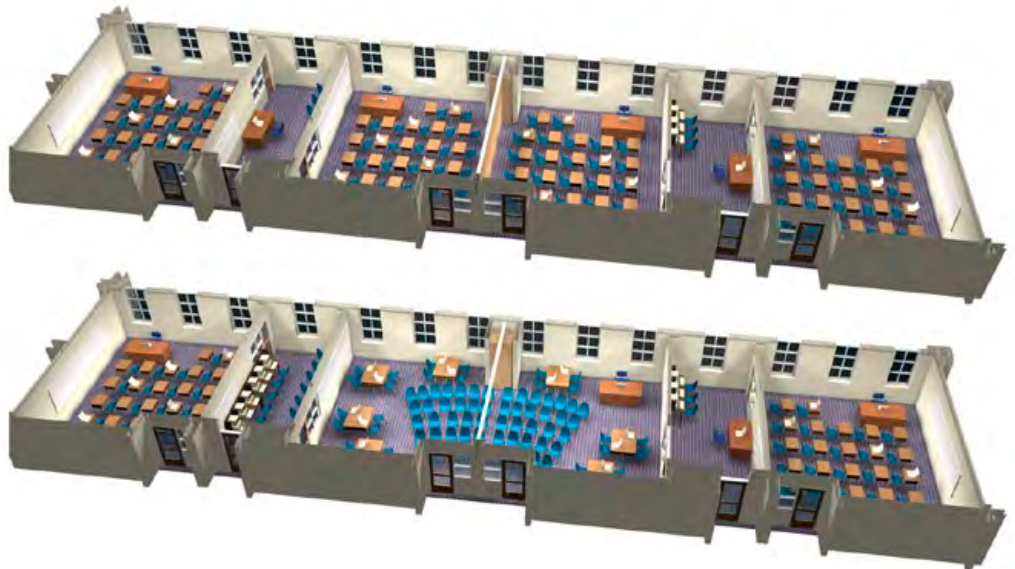

SECTION 3

EXHIBITS EXHIBIT 08

UNIVERSITY HIGH SCHOOL OF SCIENCE & ENGINEERING

HARTFORD PUBLIC SCHOOLS ON THE UNIVERSITY OF HARTFORD CAMPUS
HARTFORD, CONNECTICUT

RELEVANCE

Involved from the earliest stages of the project, Jim assisted the University of Hartford in a planning study funded by the Bill and Melinda Gates Foundation. His program guidance and design leadership resulted in school that uniquely supports an Early College Model curriculum and offers a physical connection between the private university and an urban public school system. Internet cafes on each floor overlook the main student commons and have created a college-like atmosphere in the building. In its first 4 years of operation the school became the top-performing public high school in Hartford.



DECLARATION OF RESPONSIBILITY

I have personal knowledge of the nominee's responsibility for the project listed above. That responsibility included:

principally responsible for design

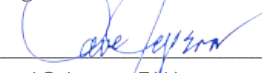

David G. Jepson, FAIA
Chairman, JCJ Architecture

TREAT STUDENTS AS APPRENTICE INVESTIGATORS

This building supports an early-college STEM program for 400 students. Jim's design evolved from a belief that the building should reflect the beauty of scientific principles; support a highly collaborative and interactive learning model; and actively promoting student collaboration with peers, teachers, administrators, and University faculty and students. The school is organized into learning communities grouped around common laboratories, project rooms and faculty advisories. Centrally located on each floor is an internet cafe - an informal space to meet, work and socialize; each of these cafes overlooks the student commons - a dynamic multi-use space that is the hub of daily activity. Bordered by 2-story curtain wall on one side and a carefully scaled interior wall that divides the commons from the classroom wing, the commons may have numerous activities at any given time - students dining, a robotics team running their latest creation or students queuing to go outside and begin an experiment. The building plan responds to a site tightly constrained by the University, utilities, wetlands, roadways and a part of the Hartford river system.

ARCHITECTURE FIRM OF RECORD/DESIGN FIRM JCJ Architecture

COMPLETION DATE 2009

ROLE OF NOMINEE Principal-in-Charge, Design Principal



AWARDS

Learning By Design Honorable
Mention 2011

LECTURES

Blurring the Boundaries; University
HS of Science and Engineering
Society of College and University
Planners National Convention 2010
Minneapolis, MN

Design of the Learning
Environment as a Tool for School
Reform
College Board Annual Leadership
Colloquium 2010
Tampa, FL

University High School of Science
and Engineering
SCUP North Atlantic Regional
Meeting 2010
Cambridge, MA

Blurring the Boundaries; University
HS of Science and Engineering
School Building Expo / CAE Spring
Meeting 2009
Pittsburgh PA



SECTION 3

EXHIBITS
EXHIBIT 09

PORTSMOUTH MIDDLE SCHOOL
PORTSMOUTH PUBLIC SCHOOLS | PORTSMOUTH, NEW HAMPSHIRE

RELEVANCE

By developing and leading a comprehensive community design program, Jim was able to assist the citizens of Portsmouth in bringing a long standing debate about the future of their Middle School to a successful conclusion. Cited by the local newspaper as "setting a new standard for public process" Jim and his team gained the confidence of city leaders and residents as they engaged in numerous design workshops and presentations over an 18 month period. The result is a renovated and expanded middle school on its original downtown site creating a sustainable, walkable, building that supports 21st century learning.

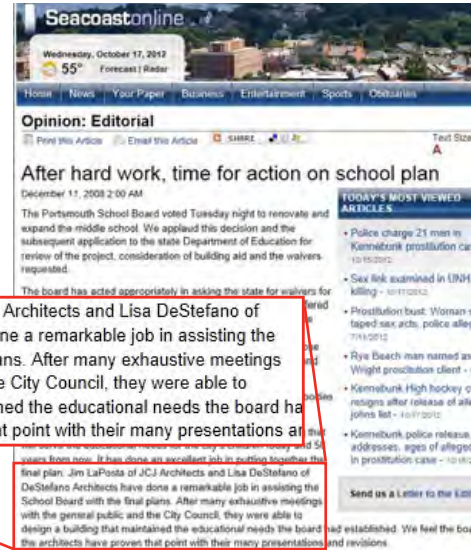
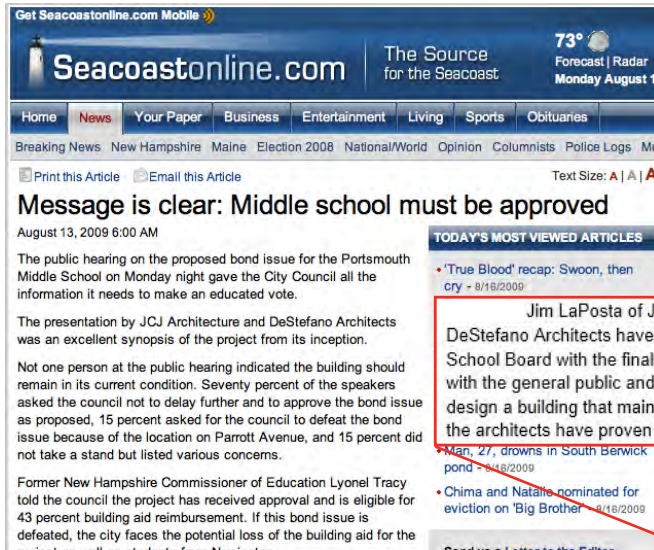

SET A NEW STANDARD FOR PUBLIC PROCESS

With earlier studies recommending the abandonment of the existing Middle School and construction of a new building outside the downtown area, Jim lead the effort to undertake a comprehensive study to assess the feasibility of renovating and expanding the existing school. Previous efforts had not only been rejected by the Portsmouth community in public votes but were contradictory to the City's ten-year master plan objective of creating a "livable, walkable community that preserves its history [and] lives in balance with its natural resources."

Jim engaged constituents from the school and the wider Portsmouth community in the design process and was able to formulate a plan that met with overwhelming approval from the public, the school community and from City officials.

DECLARATION OF RESPONSIBILITY

I have personal knowledge of the nominee's responsibility for the project listed above. That responsibility included:

principally responsible for design

David G. Jepson
David G. Jepson, FAIA
Chairman, JCJ Architecture

ARCHITECTURE FIRM OF RECORD/DESIGN FIRM JCJ Architecture
COMPLETION DATE 2012 (phase 1), 2013 (anticipated phase 2/3)
ROLE OF NOMINEE Principal-in-Charge, Design Principal

SECTION 3

EXHIBITS
EXHIBIT 10

WORLD OF INQUIRY SCHOOL NO. 58
ROCHESTER PUBLIC SCHOOLS | ROCHESTER, NEW YORK

RELEVANCE

Jim’s dedication to creating places that support new ways of teaching and learning was a perfect match for the Expeditionary Learning model at the World of Inquiry School. Guided by the schools credo that “we are crew, not passengers” Jim led his team through a multi-week immersive programming experience that engaged every aspect of the school community. The resulting design is filled with agile, informal spaces that will allow a seamless flow of varied learning activities and social interaction.

PUBLICATIONS

Expeditionary Learning
Evidence of Engagement Blog
“Architecture for a Different Type of Learning” by James E. LaPosta Jr
AIA LEED AP
September 2012

DECLARATION OF RESPONSIBILITY

I have personal knowledge of the nominee’s responsibility for the project listed above. That responsibility included:

principally responsible for design

David G. Jepson, FAIA
Chairman, JCJ Architecture



TREAT STUDENTS AS CREW, NOT PASSENGERS

Located in downtown Rochester NY, the World of Inquiry School is an Expeditionary Learning program based on an interactive, experiential and exploratory curriculum. When completed, the historic 97,000 square foot building will be fully renovated and expanded to 125,000 square feet in order to serve 800 students in grades K-12. Guided by the school’s 10 Design Principles, one of which declares that “we are crew, not passengers”, the building contains a wide variety of learning spaces outside of the classroom. Chief among these is a glass enclosed commons strategically located between the original building and the new addition. Designed to support the school’s focus on self-direction and building a strong community it will be used for large gatherings, small group instruction, and public exhibitions of student projects.

ARCHITECTURE FIRM OF RECORD/DESIGN FIRM JCJ Architecture
COMPLETION DATE 2014 (anticipated)
ROLE OF NOMINEE Principal-in-Charge, Design Principal